



Riversdale Road, N5 2SU

£550,000
Leasehold



Riversdale Road

£550,000

Leasehold

Introducing a stunning one-bedroom garden flat located on Riversdale Road, Highbury. This spacious and recently renovated residence offers an abundance of natural light, thanks to its high ceilings and open planned living room and kitchen. The bedroom features a beautiful large bay window, and spacious built in cupboards. The flat is in excellent condition, ready to move in, perfect for first-time buyers. When you step outside into the shared garden, you will be greeted with lush greenery that provides a picturesque backdrop for outdoor entertaining or simply unwinding after a long day.

Riversdale Road is quiet & perfectly located for the local amenities of Highbury, and the delightful green spaces of Clissold Park & Highbury Fields. Excellent transport links are provided via Highbury & Islington Station, Arsenal and Finsbury Park (National Rail and Victoria Line), plus many, well-connected local bus routes.

- Excellent condition
- Spacious bedroom
- 497sqft/46.1sqm
- EPC rating C
- Beautiful communal garden
- Fantastic location
- Mins walk to Highbury Barn
- Excellent transport links





Riversdale Road, Highbury, London, N5

APPROX. GROSS INTERNAL FLOOR AREA 497 SQ FT 46.1 SQ METRES

DAVID ANDREW

your most valuable asset

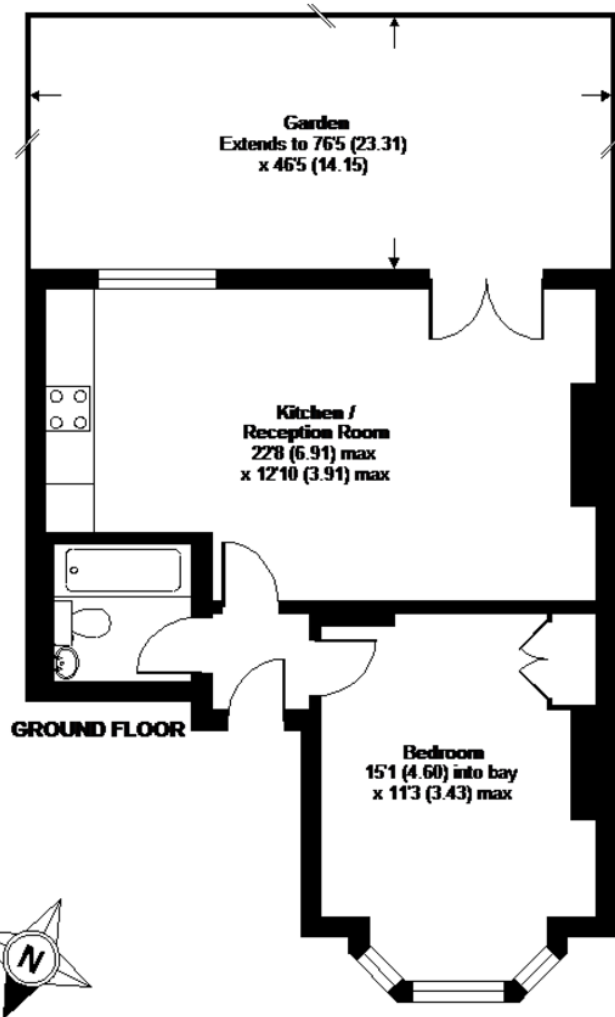

Score	Energy rating	Current	Potential
92+	A		
81-91	B		
69-80	C	73 C	80 C
55-68	D		
39-54	E		
21-38	F		
1-20	G		

Archway Office

671 Holloway Road
London, N19 5SE

T (0)20 7619 3750

Highbury Office

90 Highbury Park
London N5 2XE

T (0)20 7354 9111

Stroud Green Office

167 Stroud Green Road
London N4 3PZ

T (0)20 7281 2000

General Contact



Whilst every attempt has been made to ensure the accuracy of the floor plan contained here, measurements of doors, windows and rooms are approximate and no responsibility is taken for any error, omission or misstatement. These plans are for representation purposes only as defined by RICS Code of Measuring Practice and should be used as such by any prospective purchaser. Specifically no guarantee is given on the total square footage of the property if quoted on this plan. Any figure given is for initial guidance only and should not be relied on as a basis of valuation.

Copyright nichecom.co.uk 2013 Produced for David Andrew REF : 637737

Agent's Note:

Whilst Care has been exercised in the preparation of these sales particulars, statements about the property must not be relied upon as representations of statements or fact. Prospective purchasers must make and rely upon their own enquiries and those of professional representatives. The company accept not liability for any error contained in these particulars.

